

# Creating a Safe School Culture

---

Rome City Elementary

Principal: Heather Green  
Email: [hgreen@eastnoble.net](mailto:hgreen@eastnoble.net)  
Team: Julie Fuller, Cheryl Herber





# Background Leading to this Inquiry

- Presentation at summer seminar, led us to an inquiry of where our students felt the most and least safe.
- The Issue/Tension/Dilemma/Problem that led to your team's action research
  - After our counselor surveyed every class, surveys lead to buses being the least safe place and the safest place in the building being the office and counselor.
  - After our team reflected on the counselor's data, we noticed a huge concern for feeling unsafe on the bus.
  - Reflected on referral data and the bus referrals lead all other referrals in the school.

# Purpose of This Inquiry

- Curious where are students felt the most unsafe?
- How can we improve students social and emotional state of feeling safe at school since most of our students already face feeling unsafe at home?

The background features several sets of concentric, curved lines in shades of gray, some solid and some dashed, creating a sense of motion and depth. A large blue square with a white border and a small white triangle at the bottom center is positioned on the left side of the slide.

# Our First Actions

- Surveyed our students to inquire where they feel the safest and least safe
- Analyzed data from students' safe survey
- Reflected on all school discipline data

# Data Collection

- Guidance Counselor collected data during her guidance lessons
- Sorted through class data
- Reflected on current referral data for the building
- Continued to reflect on referral data for bus referrals

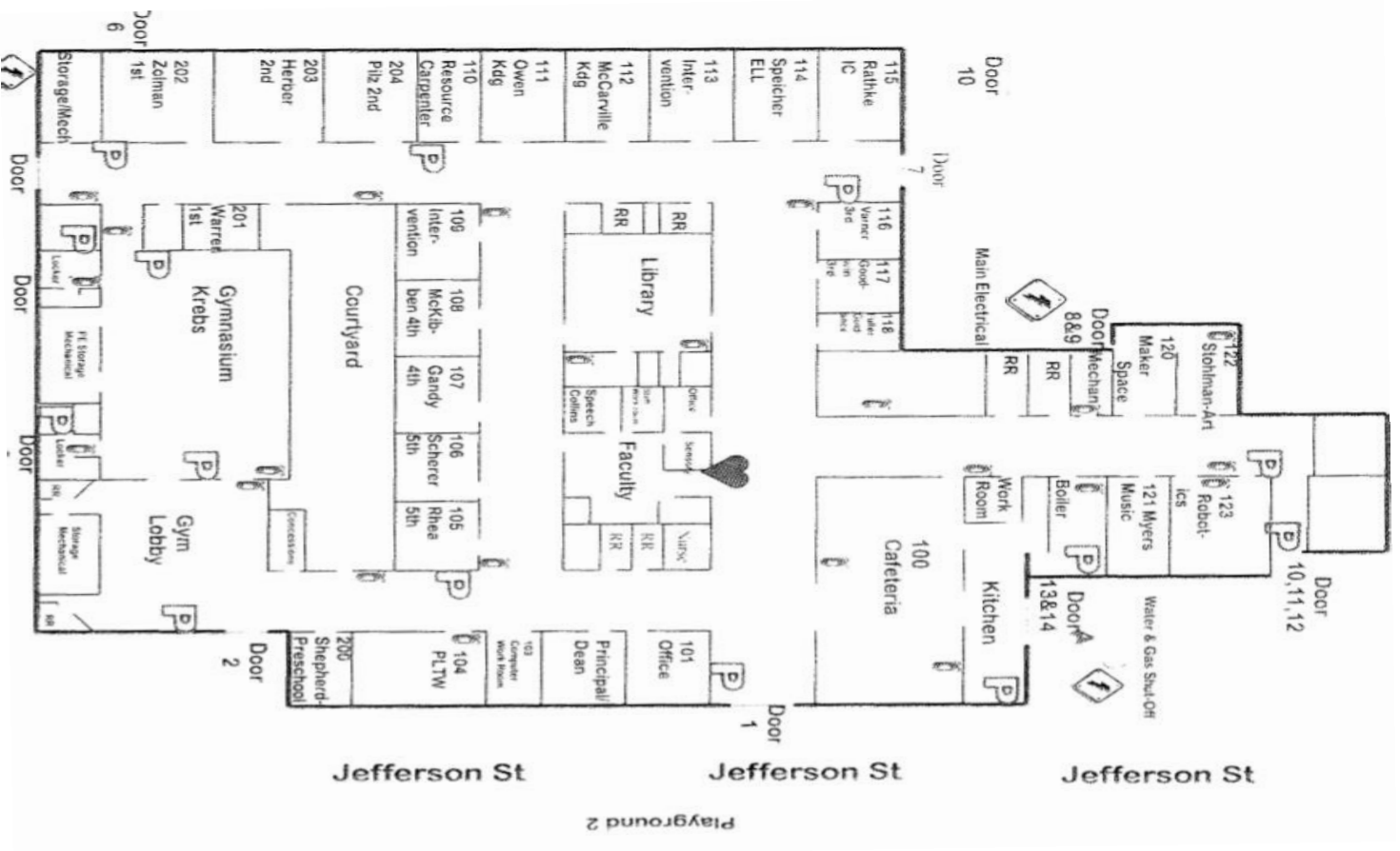



# Our Data from our First Actions

- Classroom guidance data
  1. Bus
  2. Restroom
  3. Tie with playground and hallway

# Our Wondering

- How we can improve bus safety and well-being for our students and reduce the amount of bus referrals for inappropriate behavior and actions?



# Our Follow up Actions

- Discussed as team a plan for reteaching bus procedures
- Changed bus staffing
- Scheduled bus procedures on the bus
- Continued to watch videos and pulled students who were not following procedures to discuss not following rules
- Stopped offering transportation to some students
- Making students feel they can share what is happening, offering a safe environment to share concerns with all staff involved.

# Our Data and Discoveries for Trimester 1

Location of all Referrals

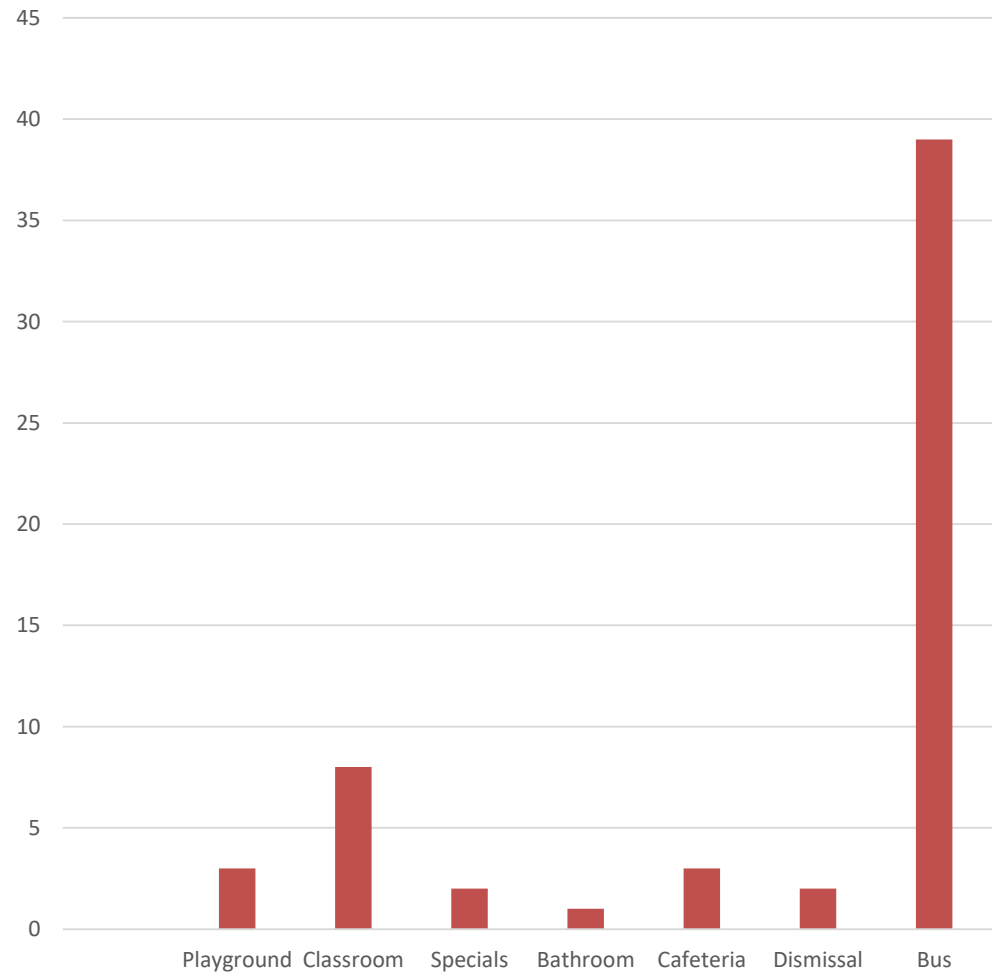

# Our Discoveries (Trimester 2)

Location of Referrals  
Trimester 2

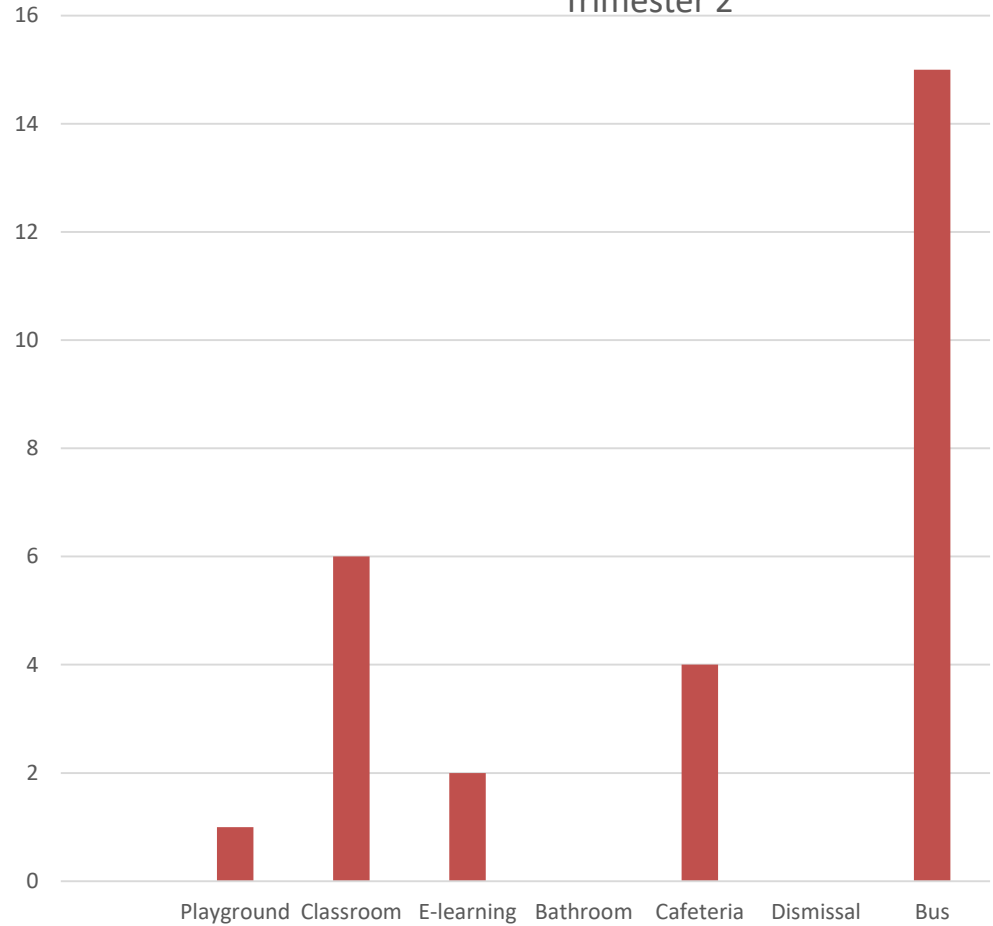

# Comparing Trimester 1 & Trimester 2

Data Comparison Trimester 1 & Trimester 2

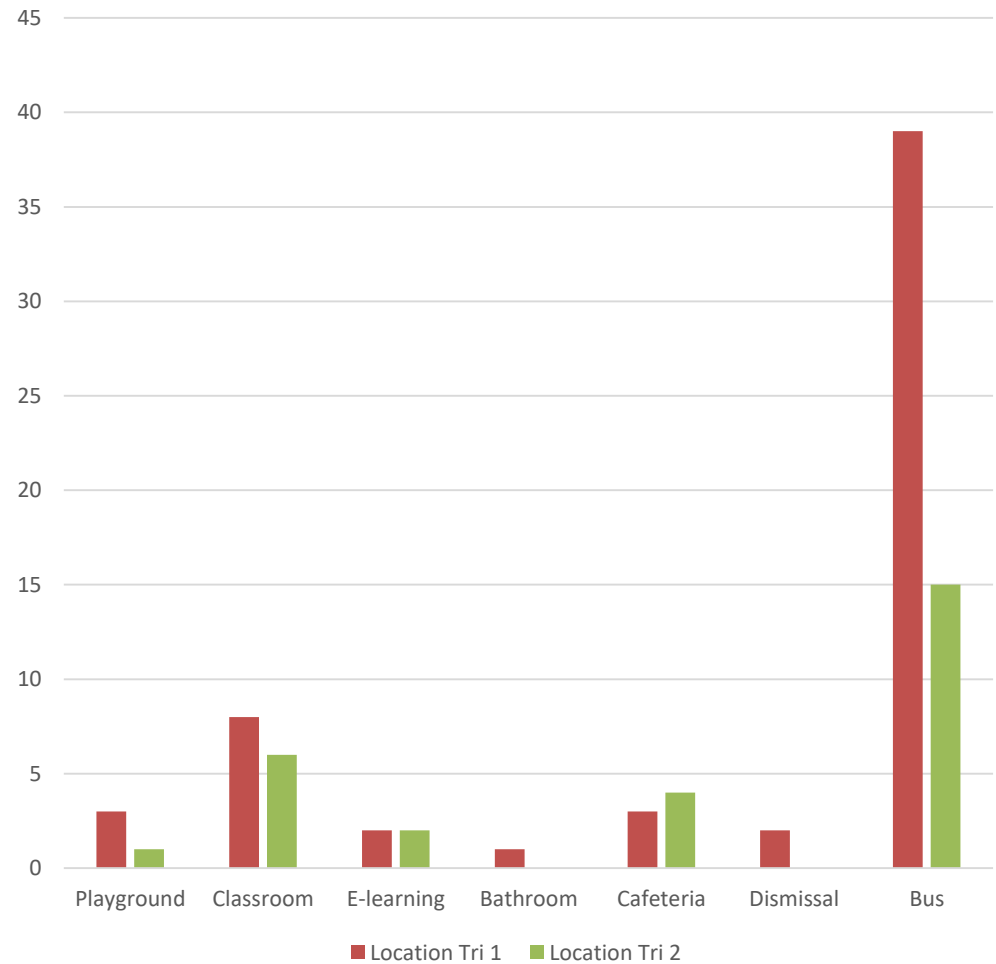



# Where We Are Heading Next

- Data shows we are heading in the right directions
- We want to continue to have bus safety talks
- Buddy system
- Staff ride the bus attend bus stops
- Continue to survey our students for safety

# Bibliography

---

9 Essential Habits that Provide  
the "Empathy Advantage"



## UnSelfie

Why Empathetic  
Kids Succeed in Our  
All-About-Me World

MICHELE BORBA, Ed.D.